

ERGONOMIC TASK CHAIR
Assembly Instruction

DIMENSIONS (MM):

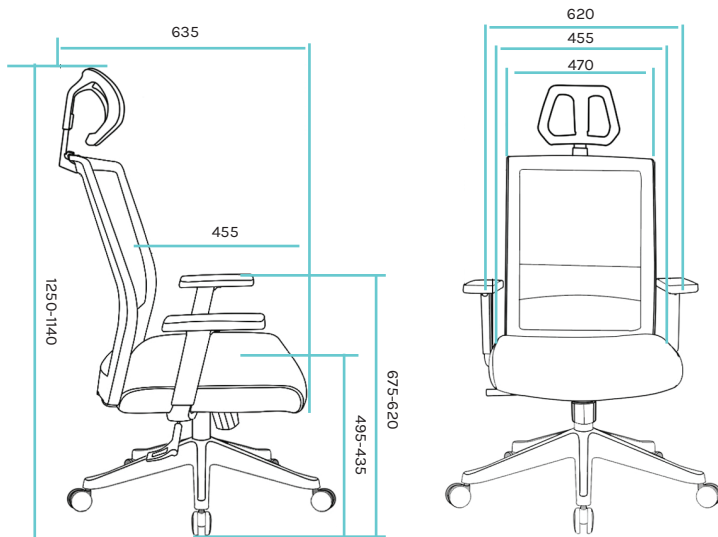

WARNING:

FAILURE TO FOLLOW THESE INSTRUCTIONS MAY RESULT IN SERIOUS INJURY:

- 1) THIS PRODUCT IS DESIGNED FOR SEATING ONLY. DO NOT STAND ON THIS PRODUCT. DO NOT USE AS A STEP LADDER.
- 2) DO NOT USE THIS PRODUCT UNLESS ALL BOLTS AND PARTS ARE FIRMLY TIGHTENED. AT LEAST WITHIN THREE MONTHS, CHECK ALL THE PARTS FOR SAFETY USE.
- 3) IF ANY PARTS ARE MISSING, DAMAGED OR WORN, STOP USING THIS PRODUCT. PREPARE THE PRODUCT WITH MANUFACTURER'S SUPPLIED PARTS.
- 4) DO NOT SIT ON THE ARM REST OF THIS PRODUCT.
- 5) THIS PRODUCT IS DESIGNED FOR SITTING ONE PERSON AT A TIME.
- 6) CHILDREN UNDER THE AGE OF 10, PLEASE USE UNDER ADULT SUPERVISION.

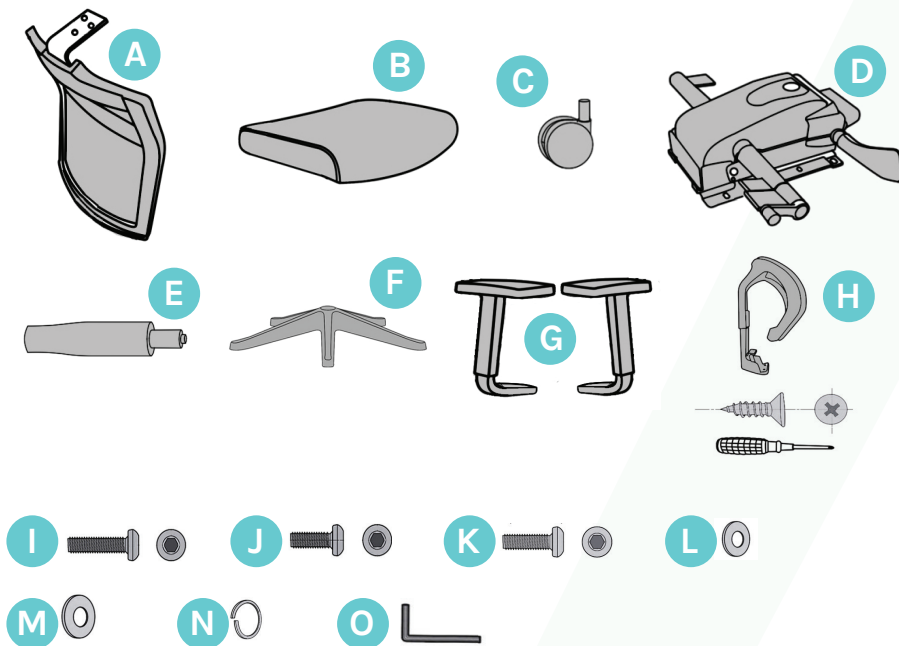

PARTS:

- A x 1
- B x 1
- C x 5
- D x 1
- E x 1
- F x 1
- G x 1 pair (L and R)
- H x 1 (use tools for headrest only)

HARDWARE:

- I M6x35 x 6
- J M6x25 x 4
- K M8x22 x 3
- L x 6
- M x 3
- N M8 x 3
- O x 1

ERGONOMIC TASK CHAIR
Assembly Instruction

STANDDESK

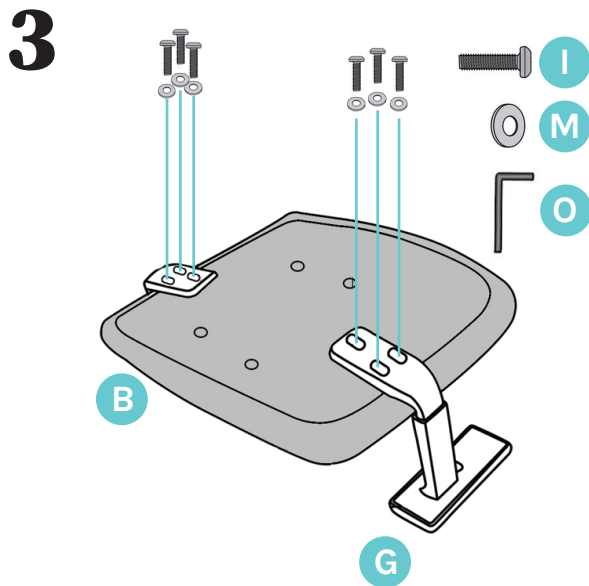
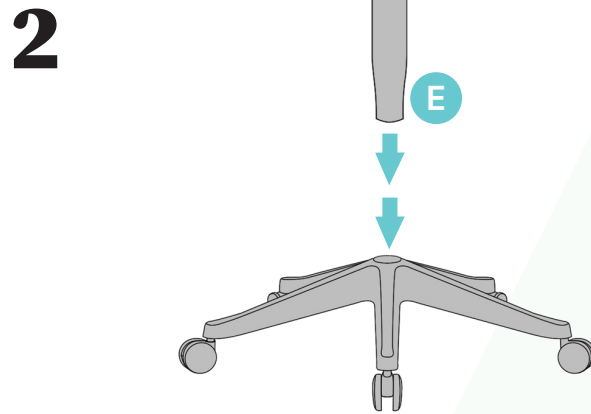
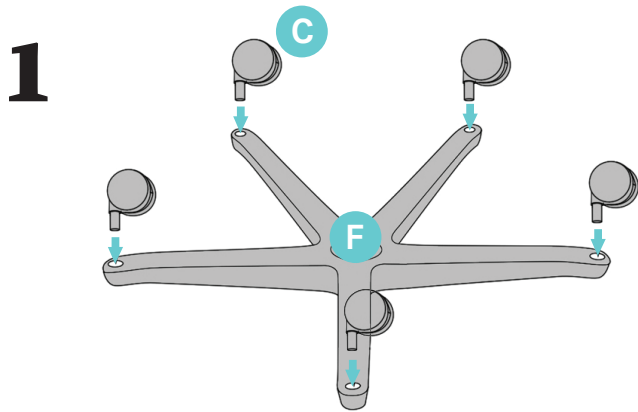

4 Raise the handle and push the mechanism to the end according to the arrow direction at the same time in order to show the screw holes.

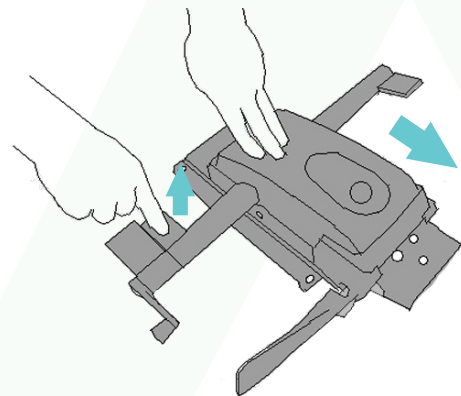

5 Keep the metal bar holes coincide with plywood before assembling the back, then tighten the screws halfway in a diagonal line.

6 Tighten the other two screws in the metal bar.

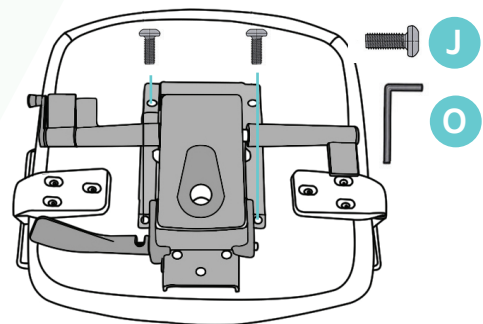
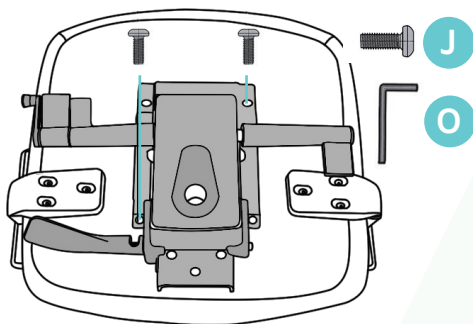

ERGONOMIC TASK CHAIR
Assembly Instruction

STANDDESK

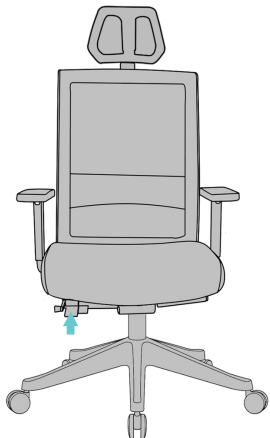
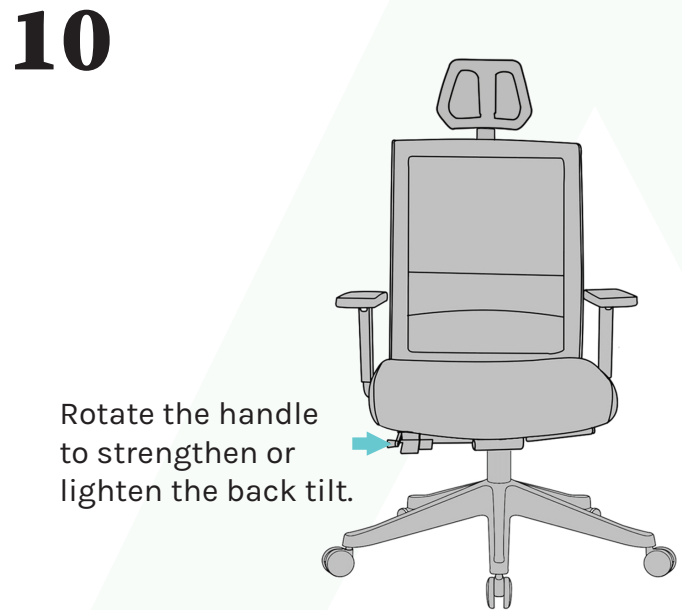
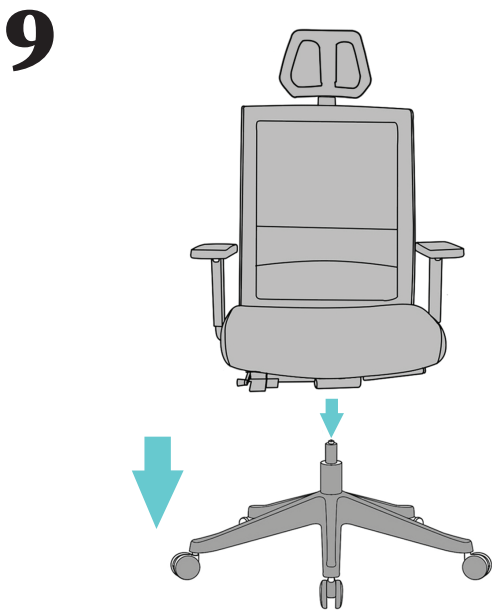
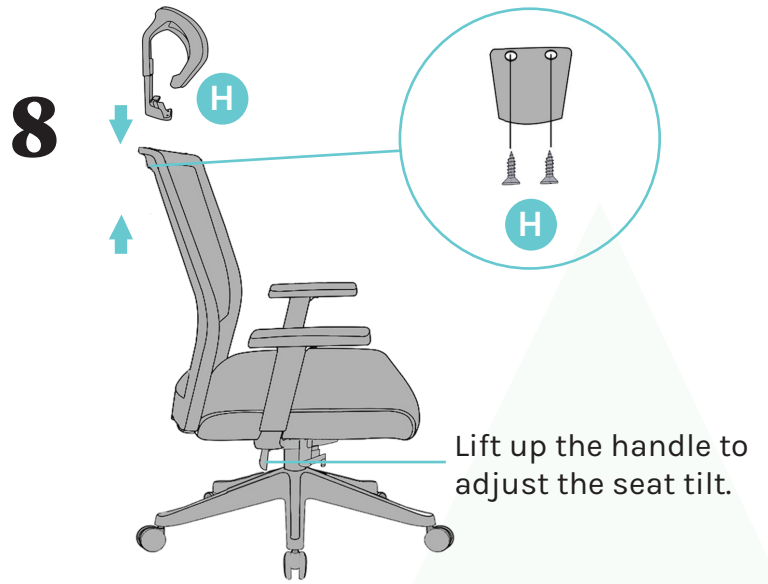
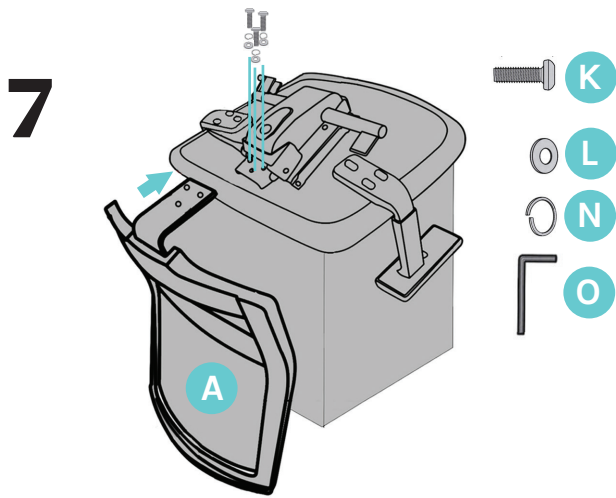

Put the handle to adjust height.

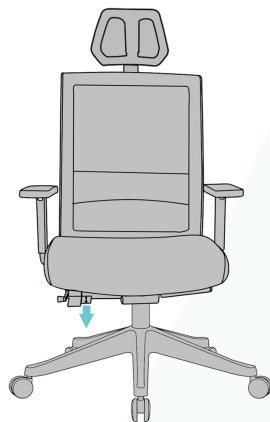

Put the handle up to make the seat move forward, the loose it to lock seat.



Adjust the handle up and down to lock or unlock the back angle.

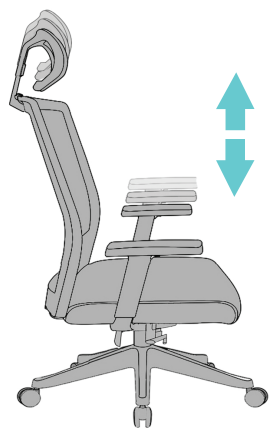

Adjust up or down.